

TABLE OF CONTENTS

1	PACKAGE CONTENTS	14
2	MECHANICAL/ACOUSTIC EQUIPMENT	15
3	CONFIGURATION OPTIONS	15
4	CONTROL PANEL	16
5	PRESET PANEL	18
6	POWER SUPPLY	18
7	BLUETOOTH® CONNECTION	19
8	QUICK SETUP	20
9	ACCESSORIES	20
10	INSTALLATION EXAMPLES	21
11	NOTES ON BATTERY USE	22
12	TROUBLESHOOTING	22
13	TECHNICAL SPECIFICATIONS	23

1 PACKAGE CONTENTS

- 1 x L206 Loudspeaker
- 1 x User Manual - Section 1
- 1 x User Manual - Section 2
- 1 x Power supply cable specific for your usage area

The warnings contained in this manual as well as the information listed in "USER MANUAL - Section 2" must be complied with.

Thank you for purchasing a Montarbo product, an Italian company founded in 1962, always at the service of music and professional audio. Montarbo products, original and cutting-edge, are designed with the utmost attention to detail and durability over time. Reliability is in line with the high quality standards and sensitivity to environmental impact that distinguish the company.

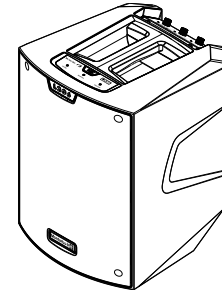

The L206 active loudspeaker, equipped with rechargeable battery and integrated 3-channel mixer, combines portability and versatility. The use is diversified: from listening as a desktop monitor to a small PA system, thanks also to an input with Bluetooth® stereo and two inputs with impedance switch and reverb control.

2 MECHANICAL/ACOUSTIC EQUIPMENT

The loudspeaker is equipped with a 6.5" woofer (voice coil: 1.5") and 5 2.5" tweeters (voice coil: 0.75"); it is compact and ergonomic and capable of delivering up to 150 W peak. Mechanical design details include a top handle and a 30° tilted side at the bottom, which allows for directional listening (e.g. for use in a monitor configuration). The bottom side also features a standard hole for assembly on tripod stand. An optional cover (dedicated accessory) allows transporting the speaker while protecting it from adverse weather conditions.

3 CONFIGURATION OPTIONS

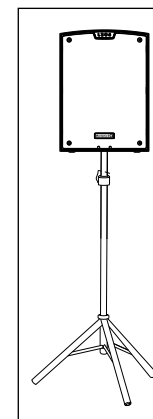

FOR FURTHER INFORMATION,
REFER TO CHAPTER 10

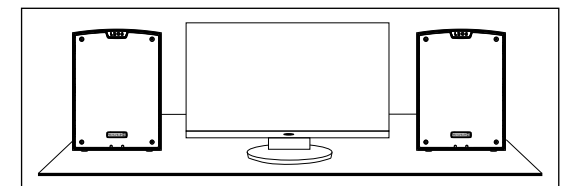
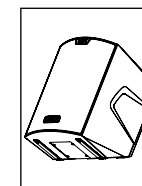

4 CONTROL PANEL

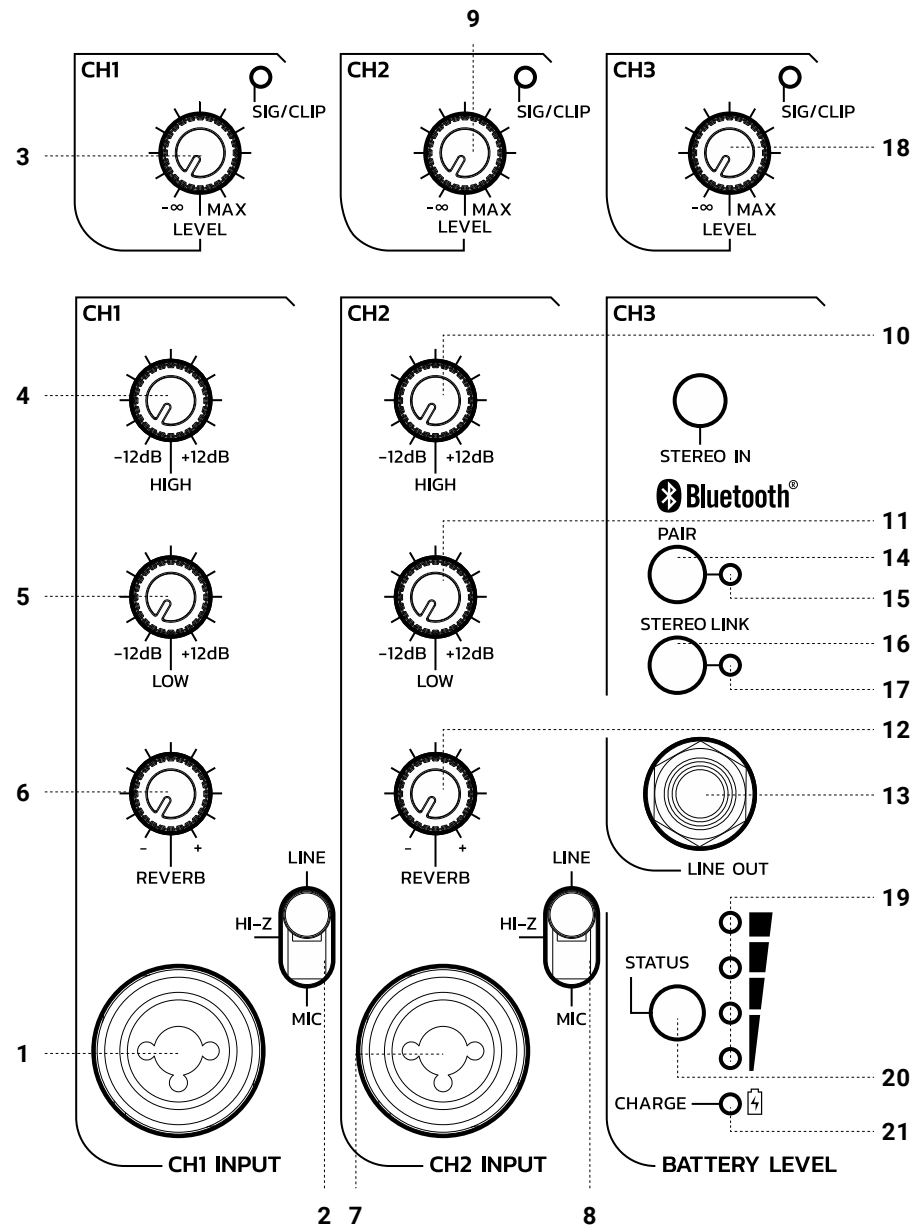

1 MIC/LINE CH1 INPUT

6.35mm XLR/jack combo input for microphone, line or high impedance signals.

2 LINE/MIC/HI-Z CH1 SWITCH

Use this switch to adjust the input sensitivity (the HI-Z position allows you to directly connect an electric guitar or bass guitar, for example)

3 LEVEL CH1

This knob adjusts the level of channel 1, turn it to the right to increase the level, to the left to reduce it.

4 HIGH CH1

High frequency equalization knob. You can attenuate (rotation to the left) or emphasize (rotation to the right) the high frequencies.

5 LOW CH1

Low frequency equalization knob. You can attenuate (rotation to the left) or emphasize (rotation to the right) the high frequencies.

6 REVERB CH1

This knob adjusts the reverb level in channel 1, turn it to the right to increase the level, to the left to reduce it, until the effect is zero.

7 MIC/LINE CH2 INPUT

6.35mm XLR/jack combo input for microphone, line or high impedance signals.

8 LINE/MIC/HI-Z CH2 SWITCH

Use this switch to adjust the input sensitivity (the HI-Z position allows you to directly connect an electric guitar or bass guitar, for example)

9 LEVEL CH2

This knob adjusts the level of channel 2, turn it to the right to increase the level, to the left to reduce it.

10 HIGH CH2

High frequency equalization knob. You can attenuate (rotation to the left) or emphasize (rotation to the right) the high frequencies.

11 LOW CH2

Low frequency equalization knob. You can attenuate (rotation to the left) or emphasize (rotation to the right) the high frequencies.

12 REVERB CH2

This knob adjusts the reverb level in channel 1, turn it to the right to increase the level, to the left to reduce it, until the effect is zero.

13 LINE OUT

Mixer signal output connector, for the link to another active speaker.

14 PAIR

This key is used to pair and connect mobile phones or tablets. For the relevant procedure, refer to chapter 7 Bluetooth® CONNECTION.

15 LED PAIR

Status light for Bluetooth® connection. It flashes while the mobile device is being paired, while it is steady on when the connection is active.

16 STEREO LINK

Key for Bluetooth® stereo pairing to a second L206.

17 LED STEREO LINK

Status indicator light flashing during the pairing to a second L206, and steady on once the stereo streaming is ensured

18 LEVEL CH3

This knob adjusts the level of channel 2, turn it to the right to increase the level, to the left to reduce it.

19 BATTERY STATUS LEDS

These LEDs indicate the battery status, and start to turn off progressively downwards as the charge decreases

20 STATUS KEY

This key only works when the unit is off. While pressed, it allows displaying the current battery charge status.

21 LED CHARGE

This LED indicates whether the device is charging or not.

5 PRESET PANEL**1 PRESET KEY**

Press this key to select the desired preset. Press the key several times to scroll through the selected preset, and the corresponding LED (STAND/GUITAR-MONITOR-SPEECH/DESKTOP) lights up. For instrument connection or conference use, select GUITAR-MONITOR-SPEECH; for further information refer to INSTALLATION EXAMPLES.

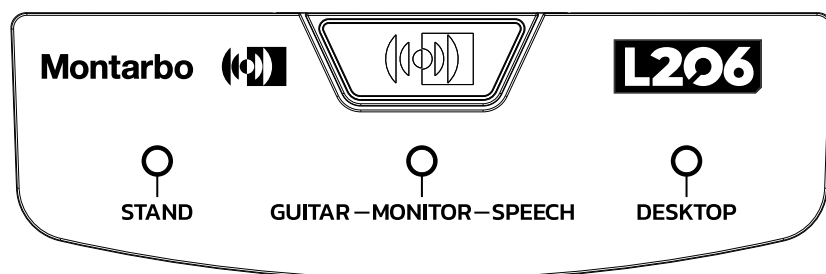
**6 POWER SUPPLY****1 MAINS INPUT**

IEC input socket with integrated mains filter. Each package includes the necessary

power supply cable, specific for your area. With the loudspeaker off, plug the power supply cable into this socket. For your safety, never disconnect the earth plug.

2 FUSE

Protection fuse.

WARNING: Only replace the fuse with one of the same type and with the same values. If the fuse continues to blow, contact an authorised service centre.

3 POWER ON/OFF/CHARGE

Switch for switching the active loudspeaker on/off. In the CHARGE position, with power supply cable connected to the mains, it recharges the internal battery. The battery is also charged when the unit is operating (ON position), but much less quickly and efficiently.

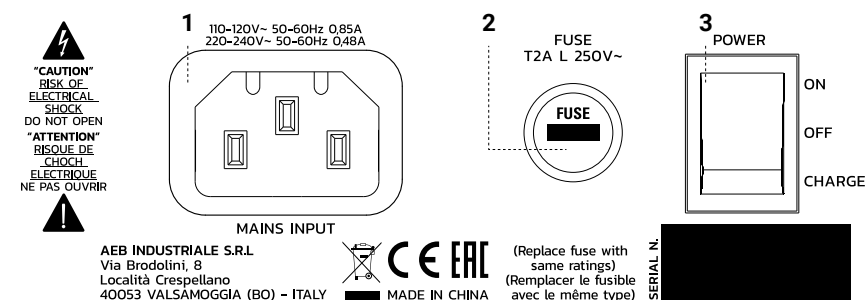
**7 BLUETOOTH® CONNECTION**

- Make sure that the device to be paired to the loudspeaker is switched on and ready for connection via Bluetooth®. With the loudspeaker on, press the PAIR key to activate Bluetooth® pairing. The relevant green LED will flash.
- Check on your mobile device that the name of the loudspeaker (e.g. B108) appears among the available devices.
- Select the loudspeaker model to pair your device. The perfect connection is indicated by the corresponding LED, which remains steady on.
- Adjust the CH3 and MAIN levels for the desired playback volume of the selected tracks in the paired device.

TO A SECOND LOUDSPEAKER

- On the first loudspeaker, already paired, press and hold the STEREO key for a few seconds. The blue LINK LED starts flashing.
- Turn on the second loudspeaker and press the PAIR button, whose LED starts flashing. Press then the STEREO key on the second loudspeaker: the relevant LINK led flashes for a few seconds (**NOTE: this last operation is required only the first time you pair the 2 loudspeakers**). Once paired, both the LINK LED of the first loudspeaker and the PAIR LED of the second loudspeaker remain steady on.
- Adjust LEVEL CH3 and MAIN of the second loudspeaker; the signal coming from the source device is emitted by both loudspeakers.

8 QUICK SETUP

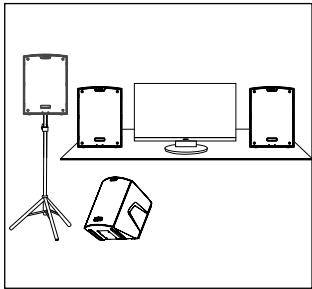

Position the loudspeaker according to the selected installation

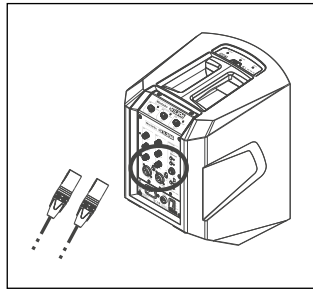

Connect the audio sources to the inputs (channel levels at zero)

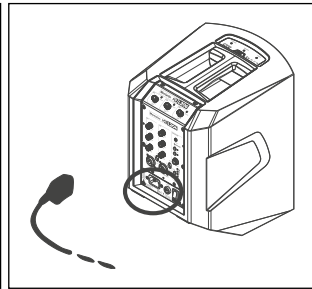

Switch the loudspeaker on, either in battery-operated portable mode or via power supply cable

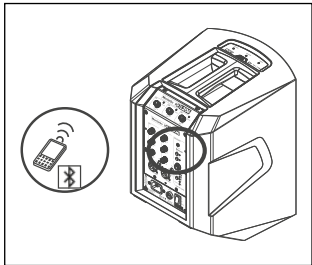

Switch on and pair the Bluetooth®

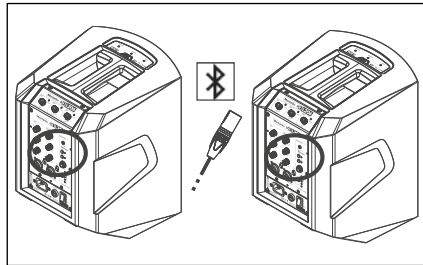

Connect additional loudspeakers (via Bluetooth® or via cables)

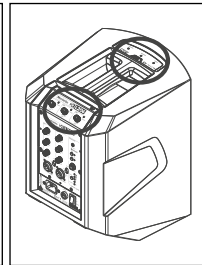

Adjust all volumes as desired, and select the correct preset

9 ACCESSORIES

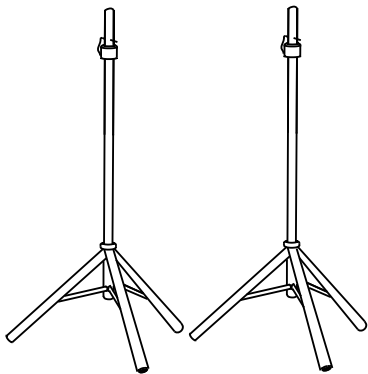

Pair of tripods

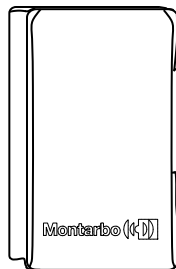

RAIN COVER

10 INSTALLATION EXAMPLES

The positioning is intuitive. For diffusion to a seated or standing audience, it is recommended to use certified stands, placed on a flat surface and with power and signal cables routed so that they cannot be trampled on, or stretched, or may constitute a reason for tripping or reduced safety.

INSTALLATION ON TRIPOD STAND

The loudspeaker can be installed on a tripod stand, coming as standard option with a 35 mm diameter pole. The maximum allowed height between the speaker base and the floor is 170 cm. Any other use requires additional fixing (not supplied). Set the preset to "STAND".

MONITOR INSTALLATION

The loudspeaker can also be positioned, by using the tilting of the cabinet bottom, as a live monitor. In this case, we recommend selecting the MONITOR preset.

DESKTOP INSTALLATION

Place the loudspeaker on your desktop at an appropriate listening distance by selecting the "DESKTOP"

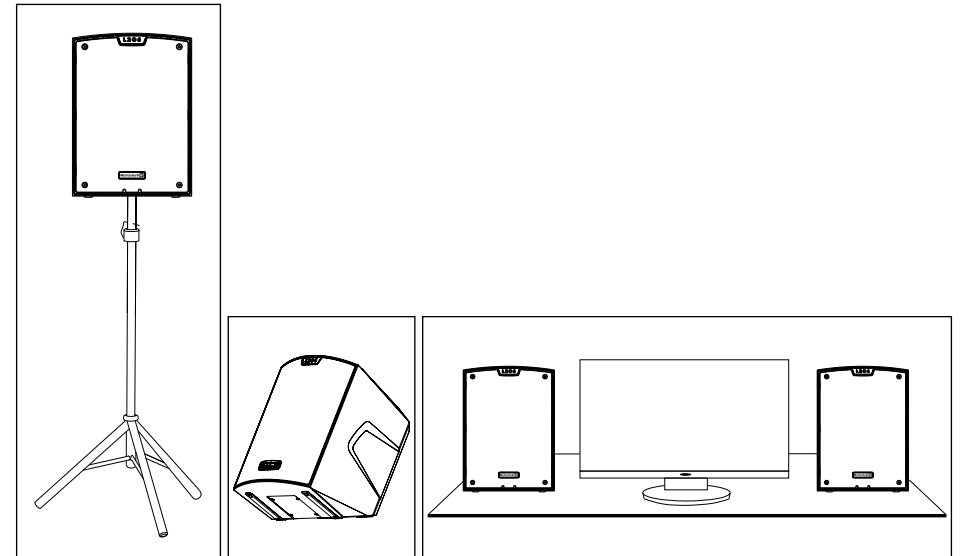

11 NOTES ON BATTERY USE

Battery average duration after a complete charge cycle is approximately 4 h, which can be decreased to halve based on the audio level set on the speaker.

This duration also depends on other factors such as:

- ambient temperature of use (generally the battery is discharged more quickly at low temperatures)
- progressive wear status due to charging/discharging cycles
- possible improper use

The average time required for the full charging, which also depends on various factors, is approximately 5 h.

12 TROUBLESHOOTING

The loudspeaker will not turn on

- Check that power supply is present upstream of the installation.
- Ensure that the power supply cable with VDE connector is properly plugged in.

The loudspeaker turns on but produces no sound

- Check that the connections to the inputs of audio channels (CH1, CH2 and/or CH3) are correct.
- Check the cables for interruptions. Use only quality cables in good condition.
- Check that the audio sources are switched on and indicate output signal.
- Check that the CH1 input sensitivity is correct.
- Check that the Bluetooth® signal is correctly paired.

Loudspeaker sound is distorted or low:

- Adjust the appropriate source volume for the mixer section inputs.
- Check the cables for damage. Use only quality cables in good condition.
- Check the volume level of the channels
- Check the output signal from the paired Bluetooth® device.
- Attenuate the level of the inputs.
- Make sure you have not connected a line signal to channels CH1 and CH2 with MIC sensitivity.

Presence of background noise

- Turn power off and disconnect all connected devices.
- Check the signal from all sources to find out which one caused the problem.

13 TECHNICAL SPECIFICATIONS

Type	All-in-one vented closure
MAX SPL (@ 1m)	114 dB
Frequency response (-10 dB)	46 Hz-20 kHz
Frequency response (-6 dB)	51Hz-19 KHz
HF	5x 2.5" (V.C.: 0.75") driver
LF	6.5" (V.C.: 1.5")
Coverage (H x V)	90° H x 40° V
Crossover frequency	1 kHz
Amplification class	D
RMS power	100 W
Peak power	150 W
Cooling	Convection
Operating voltage	100-240V~ 50-60Hz
Ambient operating temperature	-10° +40°
DSP	28/56 bit
Advanced functions	FIR filters
AD/DA converter	24 bit, 48 kHz
Bluetooth®	5.0 (stereo)
I/O connectors	CH1: Combo CH2: Combo AUX IN: mini-jack LINE OUT: jack
Controls	PRESET PANEL Level CH1-CH2-CH3 EQ - CH1-CH2 Reverb: CH1/CH2 Bluetooth®: PAIR/STEREO
Fuse	T2A L 250V~
Type of rechargeable battery	Lithium ions (Cells: 8 x 3.6 V/9 WH - 25000mAh)
Battery duration in medium conditions of usage	4 hours
Battery average charging time	5 hours
Mains power consumption at 1/3 of the power (maximum conditions of use)	0.85 A (115V~) 0.48 A (230V~)
Standby consumption	16 W
Cabinet material	Polypropylene
Dimensions (L x H x D)	247 x 339 x 286 mm (9.7" x 13.3" x 9.3")
Weight	7.5 kg (16.54 lb)

BATTERY MAINTENANCE

Battery maintenance starts from the moment you receive a new battery and continues throughout its lifetime. The main maintenance activities are indicated in the table below:

ACTIVITY	DESCRIPTION
Carry out a visual inspection	Before inserting the battery in the unit.
	Check the polarity of the terminals: red positive (+), black negative (-). Check the battery is not deformed, dented or punctured.
Charge the battery	On receiving a new battery, after use or if the low battery signal appears.
	To optimise performance, the battery should be charged as soon as possible when fully or nearly fully discharged.
The battery should be stored with a charge level of between 20% and 40%	When it is not to be used for an extended period.

CAUTION:

If allowed to discharge completely, lithium ion batteries may suffer irreparable damage that will drastically shorten their lifespan. Avoid fully discharging the battery during use in order to maintain its durability and reliability over time.

PRECAUTIONS DURING USE

Lithium ion batteries are characterised by their compact dimensions and high energy capacity. Take care when handling the battery pack; incorrect use could cause physical injury and/or material damage.

Carefully observe the following safety instructions:

- Do not short circuit the battery: make sure that the terminals do not come into contact with metal or other conductive materials during transportation and storage.
- Do not drop, crush or puncture the battery. Improper use may cause internal damage and short-circuits that may not be visible externally.
- Do not install the battery with the polarity reversed.
- Do not allow the battery to come into contact with liquids.
- Do not burn the battery or expose it to temperatures greater than 60°C.
- Do not attempt to open the battery pack or remove its internal cells.

If the battery is dropped or suffers an impact against a hard surface, regardless of its external condition:

- Stop using it immediately.
- Dispose of the battery in conformance with the applicable regulations.

BATTERY LIFESPAN

The lifespan of a lithium ion battery depends on the frequency and duration of its use. If used correctly, the internal cells will have a service life of approximately 500 charge/discharge cycles, or typically 3 years, depending on the daily usage. The risk of faults developing increases with time and depends on the conditions of use; faults may cause the battery to overheat, and in rare cases, combustion or explosion.

DISPOSAL

Discharge the battery and cover the terminals with insulating tape before disposal. Dispose of used or faulty batteries promptly and in accordance with the applicable recycling regulations.